

SOLICITUD DE CONCESIÓN DE ACUICULTURA

INFORME UAGPA N° 20

Fecha: 27/07/21

Análisis de presencia de Banco Natural

Pert	Profundidad de análisis	Especie indicada en informe	Especie o grupo a evaluar	m ² Promedio	Frecuencia de ocurrencia UM Con Rec/UM totales	% area muestreable	IPBAN	IPBANMax	Evaluación
207121238	hasta 30 metros								No se buceó

Observaciones: Profundidades del sector sobre 30 metros.



EDUARDO ANDERSON GERMAIN

Jefe Unidad Análisis y Gestión de Procesos de Acuicultura



Formulario de resultados de la evaluación directa de recursos
hidrobiológico bentónicos

Presencia de Recursos Profundidad Accidente Geográfico Tipo de Fondo

Solicitud N° 207121238	Solicitante SALMONES ISLAS DEL SUR LTDA.
---------------------------	---

Región XII	Comuna Río Verde	Area o Localidad CANAL MUÑOZ, SECTOR SUR ISLA PAN DE AZUCAR
---------------	---------------------	--

Fecha 31-May-21	Hora Inicio 14:17	Embarcación Nueva Galicia
	Hora Término 14:44	CB 3272

Carta	Shoa 11120	Area	10.00 Hás
Coordenadas Geográficas Carta Shoa 11120 :			
	Vértice	Latitud	Longitud
	A	52° 48' 16.22" S	73° 27' 57.98" O
	B	52° 48' 22.03" S	73° 27' 38.66" O
	C	52° 48' 29.29" S	73° 27' 44.70" O
	D	52° 48' 23.48" S	73° 28' 04.02" O
Coordenadas Geográficas Datum WGS84 :			
	Vértice	Latitud	Longitud
	A	52° 47' 51.18" S	73° 27' 52.04" O
	B	52° 47' 56.60" S	73° 27' 32.65" O
	C	52° 48' 03.95" S	73° 27' 38.24" O
	D	52° 47' 58.52" S	73° 27' 57.63" O

Observaciones (Anotar situaciones u observaciones que expliquen o refuercen la inspección realizada)

Superficie muestreable aprox. : 0 %

Hora de la Medición 14:17	Ajuste de Marea (mt) 1.01	Prof. Máxima 53.90 Observ.	52.89 Ajustada	Prof. Mínima 144.10 Observ.	143.09 Ajustada
------------------------------	------------------------------	----------------------------------	-------------------	-----------------------------------	--------------------



Posición geográfica de los extremos de las unidades de Muestreo (boyerines)

	Latitud	Longitud	Latitud	Longitud
Transecta N°1				
Transecta N°2				
Transecta N°3				
Transecta N°4				
Transecta N°5				
Transecta N°6				

Nombre Inspector Francisco Calderón González

Firma Inspector



Nombre Capitán/Buzo Patricio Pailapichun Yefi

Firma Capitán/Buzo

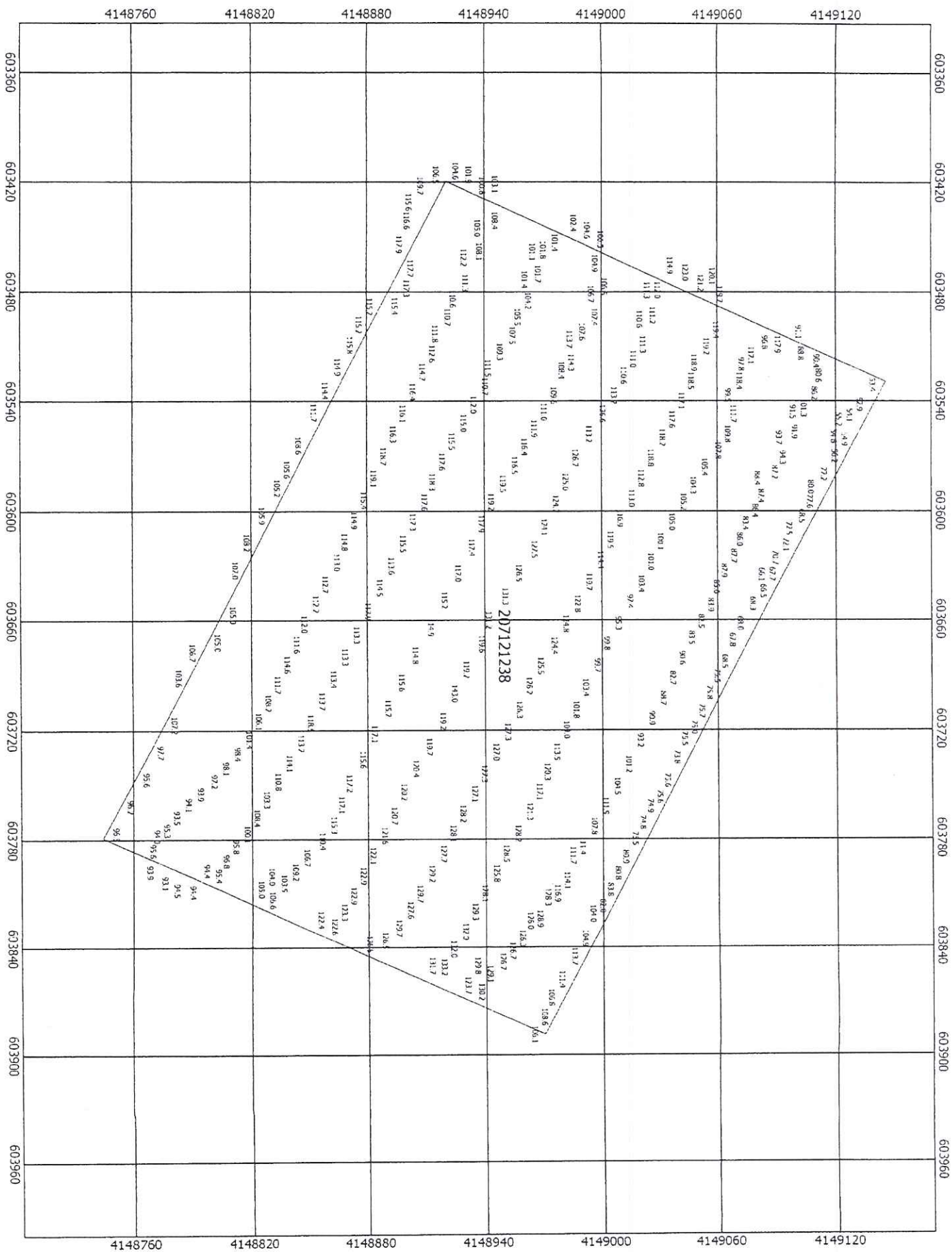

4148760

4148820

4148880

4148940

4149000

4149060

4149120

603360
603420
603480
603540
603600
603660
603720
603780
603840
603900
603960

603360
603420
603480
603540
603600
603660
603720
603780
603840
603900
603960

4148760

4148820

4148880

4148940

4149000

4149060

4149120

ID	Fecha	Hora	UTM Este	UTM Norte	Latitud	Longitud	Profundidad c prof. Corr	
1	31-05-2021	11:29:12	590.403,00	4.143.814,00	52° 50' 52,2"	73° 39' 27,4"	187,50	186,49
2	31-05-2021	11:29:17	590.410,00	4.143.802,00	52° 50' 52,5"	73° 39' 27"	189,60	188,59
3	31-05-2021	11:29:21	590.417,00	4.143.789,00	52° 50' 52,9"	73° 39' 26,6"	185,70	184,69
4	31-05-2021	11:29:26	590.424,00	4.143.776,00	52° 50' 53,4"	73° 39' 26,2"	184,70	183,69
5	31-05-2021	11:29:30	590.431,00	4.143.763,00	52° 50' 53,8"	73° 39' 25,8"	177,10	176,09
6	31-05-2021	11:29:35	590.438,00	4.143.749,00	52° 50' 54,2"	73° 39' 25,4"	176,20	175,19
7	31-05-2021	11:29:39	590.444,00	4.143.736,00	52° 50' 54,6"	73° 39' 25,1"	175,90	174,89
8	31-05-2021	11:29:44	590.452,00	4.143.723,00	52° 50' 55,1"	73° 39' 24,7"	170,40	169,39
9	31-05-2021	11:29:49	590.458,00	4.143.712,00	52° 50' 55,4"	73° 39' 24,3"	166,20	165,19
10	31-05-2021	11:29:53	590.465,00	4.143.701,00	52° 50' 55,8"	73° 39' 23,9"	167,20	166,19
11	31-05-2021	11:29:58	590.472,00	4.143.690,00	52° 50' 56,1"	73° 39' 23,6"	165,20	164,19
12	31-05-2021	11:30:02	590.479,00	4.143.680,00	52° 50' 56,4"	73° 39' 23,2"	158,10	157,09
13	31-05-2021	11:30:07	590.485,00	4.143.670,00	52° 50' 56,8"	73° 39' 22,8"	158,50	157,49
14	31-05-2021	11:30:11	590.491,00	4.143.660,00	52° 50' 57,1"	73° 39' 22,5"	156,80	155,79
15	31-05-2021	11:30:16	590.496,00	4.143.650,00	52° 50' 57,4"	73° 39' 22,2"	155,30	154,29
16	31-05-2021	11:30:20	590.501,00	4.143.640,00	52° 50' 57,7"	73° 39' 22"	155,10	154,09
17	31-05-2021	11:30:25	590.505,00	4.143.630,00	52° 50' 58"	73° 39' 21,7"	154,60	153,59
18	31-05-2021	11:30:29	590.509,00	4.143.620,00	52° 50' 58,4"	73° 39' 21,5"	149,50	148,49
19	31-05-2021	11:30:34	590.514,00	4.143.610,00	52° 50' 58,7"	73° 39' 21,2"	149,90	148,89
20	31-05-2021	11:30:38	590.519,00	4.143.600,00	52° 50' 59"	73° 39' 21"	144,90	143,89
21	31-05-2021	11:30:43	590.523,00	4.143.591,00	52° 50' 59,3"	73° 39' 20,7"	143,90	142,89
22	31-05-2021	11:30:47	590.528,00	4.143.580,00	52° 50' 59,6"	73° 39' 20,5"	140,80	139,79
23	31-05-2021	11:30:52	590.531,00	4.143.570,00	52° 51' 0"	73° 39' 20,3"	139,00	137,99
24	31-05-2021	11:30:57	590.535,00	4.143.560,00	52° 51' 0,3"	73° 39' 20,1"	93,50	92,49
25	31-05-2021	11:31:01	590.540,00	4.143.550,00	52° 51' 0,6"	73° 39' 19,8"	87,50	86,49
26	31-05-2021	11:31:06	590.543,00	4.143.540,00	52° 51' 0,9"	73° 39' 19,6"	80,80	79,79
27	31-05-2021	11:31:10	590.547,00	4.143.530,00	52° 51' 1,2"	73° 39' 19,4"	80,10	79,09
28	31-05-2021	11:31:15	590.552,00	4.143.521,00	52° 51' 1,6"	73° 39' 19,1"	79,40	78,39
29	31-05-2021	11:31:19	590.556,00	4.143.511,00	52° 51' 1,9"	73° 39' 18,9"	77,50	76,49
30	31-05-2021	11:31:24	590.560,00	4.143.501,00	52° 51' 2,2"	73° 39' 18,7"	78,30	77,29
31	31-05-2021	11:31:28	590.565,00	4.143.492,00	52° 51' 2,5"	73° 39' 18,4"	73,30	72,29
32	31-05-2021	11:31:33	590.569,00	4.143.482,00	52° 51' 2,8"	73° 39' 18,2"	74,90	73,89
33	31-05-2021	11:31:37	590.573,00	4.143.473,00	52° 51' 3,1"	73° 39' 17,9"	57,40	56,39
34	31-05-2021	11:31:42	590.576,00	4.143.462,00	52° 51' 3,4"	73° 39' 17,8"	54,80	53,79
35	31-05-2021	11:31:46	590.580,00	4.143.453,00	52° 51' 3,7"	73° 39' 17,5"	53,40	52,39
36	31-05-2021	11:31:51	590.585,00	4.143.443,00	52° 51' 4,1"	73° 39' 17,3"	49,00	47,99
37	31-05-2021	11:31:56	590.589,00	4.143.433,00	52° 51' 4,4"	73° 39' 17,1"	47,60	46,59
38	31-05-2021	11:32:00	590.593,00	4.143.424,00	52° 51' 4,7"	73° 39' 16,8"	42,50	41,49
39	31-05-2021	11:32:05	590.598,00	4.143.414,00	52° 51' 5"	73° 39' 16,6"	46,70	45,69
40	31-05-2021	11:32:09	590.603,00	4.143.404,00	52° 51' 5,3"	73° 39' 16,3"	45,20	44,19
41	31-05-2021	11:32:14	590.608,00	4.143.395,00	52° 51' 5,6"	73° 39' 16"	41,50	40,49
42	31-05-2021	11:32:18	590.612,00	4.143.385,00	52° 51' 5,9"	73° 39' 15,8"	36,80	35,79
43	31-05-2021	11:32:23	590.616,00	4.143.375,00	52° 51' 6,2"	73° 39' 15,6"	33,10	32,09
44	31-05-2021	11:32:27	590.620,00	4.143.366,00	52° 51' 6,5"	73° 39' 15,3"	26,50	25,49
45	31-05-2021	11:32:32	590.625,00	4.143.356,00	52° 51' 6,8"	73° 39' 15,1"	22,40	21,40
46	31-05-2021	11:32:36	590.628,00	4.143.347,00	52° 51' 7,1"	73° 39' 14,9"	18,80	17,80
47	31-05-2021	11:32:41	590.631,00	4.143.338,00	52° 51' 7,4"	73° 39' 14,7"	18,10	17,10
48	31-05-2021	11:32:45	590.635,00	4.143.330,00	52° 51' 7,7"	73° 39' 14,5"	15,40	14,40
49	31-05-2021	11:32:50	590.641,00	4.143.323,00	52° 51' 7,9"	73° 39' 14,2"	17,60	16,60
50	31-05-2021	11:32:54	590.646,00	4.143.318,00	52° 51' 8"	73° 39' 13,9"	17,40	16,40
51	31-05-2021	11:32:59	590.652,00	4.143.314,00	52° 51' 8,2"	73° 39' 13,6"	19,00	18,00
52	31-05-2021	11:33:04	590.658,00	4.143.314,00	52° 51' 8,2"	73° 39' 13,2"	19,00	18,00
53	31-05-2021	11:33:08	590.663,00	4.143.314,00	52° 51' 8,2"	73° 39' 13"	19,80	18,80
54	31-05-2021	11:33:13	590.669,00	4.143.316,00	52° 51' 8,1"	73° 39' 12,7"	19,90	18,90

55	31-05-2021	11:33:17	590.674,00	4.143.318,00	52° 51' 8"	73° 39' 12,4"	20,70	19,70
56	31-05-2021	11:33:22	590.679,00	4.143.321,00	52° 51' 7,9"	73° 39' 12,1"	22,80	21,80
57	31-05-2021	11:33:26	590.685,00	4.143.323,00	52° 51' 7,8"	73° 39' 11,8"	23,60	22,60
58	31-05-2021	11:33:31	590.692,00	4.143.326,00	52° 51' 7,8"	73° 39' 11,5"	24,90	23,90
59	31-05-2021	11:33:35	590.698,00	4.143.329,00	52° 51' 7,7"	73° 39' 11,1"	25,50	24,50
60	31-05-2021	11:33:40	590.705,00	4.143.331,00	52° 51' 7,6"	73° 39' 10,8"	26,80	25,80
61	31-05-2021	11:33:44	590.713,00	4.143.333,00	52° 51' 7,5"	73° 39' 10,3"	32,00	31,00
62	31-05-2021	11:33:49	590.720,00	4.143.335,00	52° 51' 7,4"	73° 39' 10"	39,00	38,00
63	31-05-2021	11:33:53	590.727,00	4.143.338,00	52° 51' 7,4"	73° 39' 9,6"	40,20	39,20
64	31-05-2021	11:33:58	590.734,00	4.143.342,00	52° 51' 7,2"	73° 39' 9,2"	42,80	41,80
65	31-05-2021	11:34:02	590.739,00	4.143.347,00	52° 51' 7,1"	73° 39' 8,9"	43,50	42,50
66	31-05-2021	11:34:07	590.742,00	4.143.353,00	52° 51' 6,9"	73° 39' 8,8"	45,60	44,60
67	31-05-2021	11:34:11	590.743,00	4.143.360,00	52° 51' 6,6"	73° 39' 8,7"	49,60	48,60
68	31-05-2021	11:34:16	590.741,00	4.143.367,00	52° 51' 6,4"	73° 39' 8,8"	51,30	50,30
69	31-05-2021	11:34:21	590.738,00	4.143.374,00	52° 51' 6,2"	73° 39' 9"	50,60	49,60
70	31-05-2021	11:34:25	590.735,00	4.143.380,00	52° 51' 6"	73° 39' 9,2"	48,80	47,80
71	31-05-2021	11:34:30	590.731,00	4.143.385,00	52° 51' 5,8"	73° 39' 9,4"	48,50	47,50
72	31-05-2021	11:34:34	590.727,00	4.143.390,00	52° 51' 5,7"	73° 39' 9,6"	48,10	47,10
73	31-05-2021	11:34:39	590.723,00	4.143.397,00	52° 51' 5,5"	73° 39' 9,8"	45,70	44,70
74	31-05-2021	11:34:43	590.719,00	4.143.403,00	52° 51' 5,2"	73° 39' 10,1"	49,60	48,60
75	31-05-2021	11:34:48	590.715,00	4.143.410,00	52° 51' 5"	73° 39' 10,3"	47,70	46,70
76	31-05-2021	11:34:52	590.711,00	4.143.417,00	52° 51' 4,8"	73° 39' 10,5"	48,60	47,60
77	31-05-2021	11:34:57	590.706,00	4.143.424,00	52° 51' 4,6"	73° 39' 10,8"	50,80	49,80
78	31-05-2021	11:35:01	590.702,00	4.143.430,00	52° 51' 4,4"	73° 39' 11"	56,50	55,50
79	31-05-2021	11:35:06	590.697,00	4.143.438,00	52° 51' 4,1"	73° 39' 11,3"	57,60	56,60
80	31-05-2021	11:35:10	590.693,00	4.143.446,00	52° 51' 3,9"	73° 39' 11,5"	64,70	63,70
81	31-05-2021	11:35:15	590.688,00	4.143.454,00	52° 51' 3,6"	73° 39' 11,8"	67,00	66,00
82	31-05-2021	11:35:19	590.682,00	4.143.462,00	52° 51' 3,4"	73° 39' 12,1"	73,10	72,10
83	31-05-2021	11:35:24	590.677,00	4.143.472,00	52° 51' 3"	73° 39' 12,4"	105,30	104,30
84	31-05-2021	11:35:28	590.670,00	4.143.484,00	52° 51' 2,7"	73° 39' 12,8"	102,30	101,30
85	31-05-2021	11:35:33	590.664,00	4.143.497,00	52° 51' 2,2"	73° 39' 13,1"	101,10	100,10
86	31-05-2021	11:35:37	590.656,00	4.143.511,00	52° 51' 1,8"	73° 39' 13,5"	104,50	103,50
87	31-05-2021	11:35:42	590.648,00	4.143.524,00	52° 51' 1,4"	73° 39' 14"	127,30	126,30
88	31-05-2021	11:35:46	590.639,00	4.143.538,00	52° 51' 0,9"	73° 39' 14,5"	133,10	132,10
89	31-05-2021	11:35:51	590.628,00	4.143.552,00	52° 51' 0,5"	73° 39' 15,1"	129,50	128,50
90	31-05-2021	11:35:56	590.618,00	4.143.566,00	52° 51' 0"	73° 39' 15,6"	137,00	136,00
91	31-05-2021	11:36:00	590.608,00	4.143.581,00	52° 50' 59,6"	73° 39' 16,2"	141,90	140,90
92	31-05-2021	11:36:05	590.599,00	4.143.595,00	52° 50' 59,1"	73° 39' 16,7"	143,30	142,30
93	31-05-2021	11:36:09	590.591,00	4.143.609,00	52° 50' 58,7"	73° 39' 17,1"	150,60	149,60
94	31-05-2021	11:36:14	590.581,00	4.143.624,00	52° 50' 58,2"	73° 39' 17,7"	147,50	146,50
95	31-05-2021	11:36:18	590.572,00	4.143.638,00	52° 50' 57,7"	73° 39' 18,2"	151,50	150,50
96	31-05-2021	11:36:23	590.563,00	4.143.653,00	52° 50' 57,2"	73° 39' 18,6"	151,30	150,30
97	31-05-2021	11:36:27	590.554,00	4.143.668,00	52° 50' 56,8"	73° 39' 19,1"	153,70	152,70
98	31-05-2021	11:36:32	590.545,00	4.143.683,00	52° 50' 56,3"	73° 39' 19,6"	155,50	154,50
99	31-05-2021	11:36:36	590.537,00	4.143.699,00	52° 50' 55,8"	73° 39' 20,1"	158,30	157,30
100	31-05-2021	11:36:41	590.529,00	4.143.714,00	52° 50' 55,3"	73° 39' 20,6"	160,80	159,80
101	31-05-2021	11:36:45	590.520,00	4.143.729,00	52° 50' 54,8"	73° 39' 21"	164,30	163,30
102	31-05-2021	11:36:50	590.510,00	4.143.743,00	52° 50' 54,4"	73° 39' 21,6"	168,40	167,40
103	31-05-2021	11:36:54	590.501,00	4.143.757,00	52° 50' 53,9"	73° 39' 22,1"	173,50	172,50
104	31-05-2021	11:36:59	590.491,00	4.143.768,00	52° 50' 53,6"	73° 39' 22,6"	179,60	178,60
105	31-05-2021	11:37:03	590.478,00	4.143.774,00	52° 50' 53,4"	73° 39' 23,3"	176,70	175,70
106	31-05-2021	11:37:08	590.466,00	4.143.775,00	52° 50' 53,4"	73° 39' 24"	177,70	176,70
107	31-05-2021	11:37:12	590.456,00	4.143.771,00	52° 50' 53,5"	73° 39' 24,5"	178,00	177,00
108	31-05-2021	11:37:17	590.445,00	4.143.764,00	52° 50' 53,7"	73° 39' 25,1"	177,20	176,20
109	31-05-2021	11:37:21	590.437,00	4.143.755,00	52° 50' 54"	73° 39' 25,5"	176,20	175,20

110	31-05-2021	11:37:26	590.430,00	4.143.746,00	52° 50' 54,3"	73° 39' 25,9"	176,90	175,90
111	31-05-2021	11:37:30	590.422,00	4.143.736,00	52° 50' 54,6"	73° 39' 26,3"	178,10	177,10
112	31-05-2021	11:37:35	590.413,00	4.143.729,00	52° 50' 54,9"	73° 39' 26,8"	174,30	173,30
113	31-05-2021	11:37:39	590.403,00	4.143.723,00	52° 50' 55,1"	73° 39' 27,3"	175,40	174,40
114	31-05-2021	11:37:44	590.391,00	4.143.717,00	52° 50' 55,3"	73° 39' 27,9"	175,30	174,31
115	31-05-2021	11:37:48	590.379,00	4.143.712,00	52° 50' 55,5"	73° 39' 28,6"	176,60	175,61
116	31-05-2021	11:37:53	590.367,00	4.143.706,00	52° 50' 55,7"	73° 39' 29,2"	177,50	176,51
117	31-05-2021	11:37:57	590.355,00	4.143.699,00	52° 50' 55,9"	73° 39' 29,8"	179,60	178,61
118	31-05-2021	11:38:02	590.343,00	4.143.694,00	52° 50' 56,1"	73° 39' 30,5"	181,50	180,51
119	31-05-2021	11:38:06	590.330,00	4.143.688,00	52° 50' 56,3"	73° 39' 31,1"	184,70	183,71
120	31-05-2021	11:38:11	590.318,00	4.143.681,00	52° 50' 56,5"	73° 39' 31,8"	186,80	185,81
121	31-05-2021	11:38:15	590.306,00	4.143.674,00	52° 50' 56,7"	73° 39' 32,4"	188,30	187,31
122	31-05-2021	11:38:20	590.292,00	4.143.668,00	52° 50' 57"	73° 39' 33,1"	192,40	191,41
123	31-05-2021	11:38:25	590.279,00	4.143.661,00	52° 50' 57,2"	73° 39' 33,9"	191,60	190,61
124	31-05-2021	11:38:29	590.265,00	4.143.654,00	52° 50' 57,4"	73° 39' 34,6"	192,40	191,41
125	31-05-2021	11:38:34	590.253,00	4.143.647,00	52° 50' 57,6"	73° 39' 35,2"	174,40	173,41
126	31-05-2021	11:38:38	590.242,00	4.143.637,00	52° 50' 58"	73° 39' 35,8"	173,50	172,51
127	31-05-2021	11:38:43	590.235,00	4.143.626,00	52° 50' 58,3"	73° 39' 36,2"	183,20	182,21
128	31-05-2021	11:38:47	590.232,00	4.143.614,00	52° 50' 58,7"	73° 39' 36,3"	166,80	165,81
129	31-05-2021	11:38:52	590.232,00	4.143.602,00	52° 50' 59,1"	73° 39' 36,3"	160,40	159,41
130	31-05-2021	11:38:56	590.235,00	4.143.592,00	52° 50' 59,4"	73° 39' 36,1"	161,10	160,11
131	31-05-2021	11:39:01	590.241,00	4.143.583,00	52° 50' 59,7"	73° 39' 35,8"	149,10	148,11
132	31-05-2021	11:39:05	590.248,00	4.143.576,00	52° 51' 0"	73° 39' 35,4"	137,30	136,31
133	31-05-2021	11:39:10	590.256,00	4.143.567,00	52° 51' 0,2"	73° 39' 35"	137,10	136,11
134	31-05-2021	11:39:14	590.262,00	4.143.557,00	52° 51' 0,5"	73° 39' 34,6"	129,00	128,01
135	31-05-2021	11:39:19	590.269,00	4.143.548,00	52° 51' 0,8"	73° 39' 34,3"	125,00	124,01
136	31-05-2021	11:39:23	590.274,00	4.143.537,00	52° 51' 1,2"	73° 39' 34"	106,50	105,51
137	31-05-2021	11:39:28	590.281,00	4.143.526,00	52° 51' 1,5"	73° 39' 33,6"	113,70	112,71
138	31-05-2021	11:39:33	590.288,00	4.143.516,00	52° 51' 1,9"	73° 39' 33,2"	99,70	98,71
139	31-05-2021	11:39:37	590.295,00	4.143.505,00	52° 51' 2,2"	73° 39' 32,8"	87,80	86,81
140	31-05-2021	11:39:42	590.303,00	4.143.494,00	52° 51' 2,6"	73° 39' 32,4"	87,40	86,41
141	31-05-2021	11:39:46	590.310,00	4.143.484,00	52° 51' 2,9"	73° 39' 32"	77,40	76,41
142	31-05-2021	11:39:51	590.318,00	4.143.474,00	52° 51' 3,2"	73° 39' 31,6"	58,60	57,61
143	31-05-2021	11:39:55	590.326,00	4.143.466,00	52° 51' 3,5"	73° 39' 31,1"	43,80	42,81
144	31-05-2021	11:40:00	590.334,00	4.143.457,00	52° 51' 3,8"	73° 39' 30,7"	41,90	40,91
145	31-05-2021	11:40:04	590.342,00	4.143.447,00	52° 51' 4"	73° 39' 30,3"	34,20	33,21
146	31-05-2021	11:40:09	590.350,00	4.143.439,00	52° 51' 4,3"	73° 39' 29,8"	26,90	25,91
147	31-05-2021	11:40:14	590.359,00	4.143.433,00	52° 51' 4,5"	73° 39' 29,3"	18,80	17,81
148	31-05-2021	11:40:18	590.368,00	4.143.429,00	52° 51' 4,6"	73° 39' 28,9"	18,00	17,01
149	31-05-2021	11:40:23	590.377,00	4.143.430,00	52° 51' 4,6"	73° 39' 28,4"	15,50	14,51
150	31-05-2021	11:40:27	590.385,00	4.143.434,00	52° 51' 4,4"	73° 39' 28"	15,50	14,51
151	31-05-2021	11:40:32	590.391,00	4.143.440,00	52° 51' 4,3"	73° 39' 27,6"	27,50	26,51
152	31-05-2021	11:40:36	590.397,00	4.143.445,00	52° 51' 4,1"	73° 39' 27,3"	28,00	27,01
153	31-05-2021	11:40:41	590.404,00	4.143.451,00	52° 51' 3,9"	73° 39' 27"	26,20	25,21
154	31-05-2021	11:40:45	590.410,00	4.143.456,00	52° 51' 3,7"	73° 39' 26,6"	26,30	25,31
155	31-05-2021	11:40:50	590.419,00	4.143.461,00	52° 51' 3,5"	73° 39' 26,2"	27,00	26,01
156	31-05-2021	11:40:54	590.427,00	4.143.465,00	52° 51' 3,4"	73° 39' 25,7"	26,30	25,31
157	31-05-2021	11:40:59	590.436,00	4.143.467,00	52° 51' 3,4"	73° 39' 25,2"	23,00	22,01
158	31-05-2021	11:41:04	590.446,00	4.143.466,00	52° 51' 3,4"	73° 39' 24,7"	23,70	22,71
159	31-05-2021	11:41:08	590.455,00	4.143.465,00	52° 51' 3,4"	73° 39' 24,2"	20,50	19,51
160	31-05-2021	11:41:13	590.464,00	4.143.463,00	52° 51' 3,5"	73° 39' 23,8"	18,20	17,21
161	31-05-2021	11:41:17	590.473,00	4.143.461,00	52° 51' 3,5"	73° 39' 23,3"	19,30	18,31
162	31-05-2021	11:41:22	590.482,00	4.143.458,00	52° 51' 3,6"	73° 39' 22,8"	20,50	19,51
163	31-05-2021	11:41:26	590.491,00	4.143.454,00	52° 51' 3,7"	73° 39' 22,3"	26,70	25,71
164	31-05-2021	11:41:31	590.501,00	4.143.450,00	52° 51' 3,9"	73° 39' 21,8"	28,30	27,31

165	31-05-2021	11:41:35	590.510,00	4.143.445,00	52° 51' 4"	73° 39' 21,3"	28,60	27,61
166	31-05-2021	11:41:40	590.520,00	4.143.440,00	52° 51' 4,2"	73° 39' 20,7"	27,60	26,61
167	31-05-2021	11:41:44	590.530,00	4.143.435,00	52° 51' 4,3"	73° 39' 20,2"	27,90	26,91
168	31-05-2021	11:41:49	590.539,00	4.143.430,00	52° 51' 4,5"	73° 39' 19,7"	27,00	26,01
169	31-05-2021	11:41:54	590.549,00	4.143.424,00	52° 51' 4,7"	73° 39' 19,2"	29,20	28,21
170	31-05-2021	11:41:58	590.558,00	4.143.418,00	52° 51' 4,9"	73° 39' 18,7"	31,40	30,41
171	31-05-2021	11:42:03	590.569,00	4.143.411,00	52° 51' 5,1"	73° 39' 18,1"	35,00	34,01
172	31-05-2021	11:42:07	590.581,00	4.143.403,00	52° 51' 5,3"	73° 39' 17,5"	31,20	30,21
173	31-05-2021	11:42:12	590.593,00	4.143.396,00	52° 51' 5,6"	73° 39' 16,8"	33,80	32,81
174	31-05-2021	11:42:16	590.605,00	4.143.388,00	52° 51' 5,8"	73° 39' 16,2"	38,10	37,11
175	31-05-2021	11:42:21	590.618,00	4.143.380,00	52° 51' 6,1"	73° 39' 15,5"	33,60	32,61
176	31-05-2021	11:42:25	590.632,00	4.143.372,00	52° 51' 6,3"	73° 39' 14,7"	31,40	30,41
177	31-05-2021	11:42:30	590.645,00	4.143.365,00	52° 51' 6,5"	73° 39' 14"	30,90	29,91
178	31-05-2021	11:42:34	590.659,00	4.143.357,00	52° 51' 6,8"	73° 39' 13,2"	26,60	25,61
179	31-05-2021	11:42:39	590.673,00	4.143.350,00	52° 51' 7"	73° 39' 12,5"	31,10	30,11
180	31-05-2021	11:42:43	590.688,00	4.143.342,00	52° 51' 7,2"	73° 39' 11,7"	25,70	24,71
181	31-05-2021	11:42:48	590.703,00	4.143.335,00	52° 51' 7,5"	73° 39' 10,9"	27,90	26,91
182	31-05-2021	11:42:52	590.717,00	4.143.328,00	52° 51' 7,7"	73° 39' 10,1"	32,30	31,31
183	31-05-2021	11:42:57	590.732,00	4.143.322,00	52° 51' 7,9"	73° 39' 9,3"	37,40	36,41
184	31-05-2021	11:43:01	590.748,00	4.143.318,00	52° 51' 8"	73° 39' 8,4"	40,10	39,11
185	31-05-2021	11:43:06	590.764,00	4.143.319,00	52° 51' 7,9"	73° 39' 7,6"	44,60	43,62
186	31-05-2021	11:43:11	590.777,00	4.143.325,00	52° 51' 7,7"	73° 39' 6,9"	48,50	47,52
187	31-05-2021	11:43:15	590.787,00	4.143.335,00	52° 51' 7,4"	73° 39' 6,3"	56,20	55,22
188	31-05-2021	11:43:20	590.794,00	4.143.346,00	52° 51' 7,1"	73° 39' 6"	61,40	60,42
189	31-05-2021	11:43:24	590.799,00	4.143.358,00	52° 51' 6,7"	73° 39' 5,8"	63,60	62,62
190	31-05-2021	11:43:29	590.802,00	4.143.372,00	52° 51' 6,2"	73° 39' 5,6"	66,30	65,32
191	31-05-2021	11:43:33	590.803,00	4.143.386,00	52° 51' 5,7"	73° 39' 5,5"	68,00	67,02
192	31-05-2021	11:43:38	590.805,00	4.143.401,00	52° 51' 5,3"	73° 39' 5,5"	84,80	83,82
193	31-05-2021	11:43:42	590.806,00	4.143.416,00	52° 51' 4,8"	73° 39' 5,4"	89,80	88,82
194	31-05-2021	11:43:47	590.807,00	4.143.432,00	52° 51' 4,3"	73° 39' 5,4"	95,80	94,82