

División de Acuicultura

Informe UAGPA N° 17  
Fecha: 28 de marzo de 2017  
Análisis de presencia de Banco Natural

Pert	profundidad de análisis	especie indicada en informe	Especie o grupo a evaluar	m <sup>2</sup> um (1)	m <sup>2</sup> um (2)	m <sup>2</sup> um (3)	m <sup>2</sup> Promedio	frecuencia de ocurrencia UM Con Rec/UM totales	% area muestreable	IPBAN	IPBANMax	Evaluación
213122273	hasta 30 m	-	-	-	-	-	-	-	0	-	-	No se buceó

Obs: Se constata según Informe de Inspección de Terreno, que en la zona inspeccionada se cuenta con profundidades superiores a 30 metros, por lo que no se buceó.

**EDUARDO ANDERSON GERMAIN**  
Jefe Unidad Análisis y Gestión de Procesos de Acuicultura

AVR/avr  
C.I. (Subpesca) N° 1816/16.

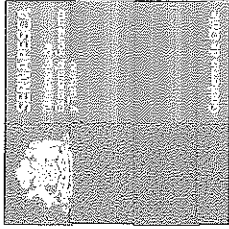

Formulario de resultados de la evaluación directa de recursos  
hidrobiológico bentónicos

Presencia de Recursos  Profundidad  Accidente Geográfico  Tipo de Fondo

Solicitud N° 213122273	Solicitante Kelp Chile Centro S.A.
---------------------------	---------------------------------------

Región XII	Comuna Natales	Area o Localidad Península Antonio Varas, Al Sureste De Isla Ballesteros, Sector 73
---------------	-------------------	---

Fecha 03-Dic-15	Hora Inicio 16:50	Embarcación Explorador Patagonia
	Hora Término 17:15	CB 2279

Carta Shoa 10600 (Datum SAD69) Area 25,00 Háas

Coordenadas Geográficas Carta Shoa 10600 :	Vértice	Latitud	Longitud
	A	51° 47' 43,90" S	72° 49' 23,62" O
	B	51° 47' 50,63" S	72° 48' 59,89" O
	C	51° 48' 05,35" S	72° 49' 10,75" O
	D	51° 47' 58,61" S	72° 49' 34,48" O

Observaciones (Anotar situaciones u observaciones que expliquen o refuercen la inspección realizada)

Superficie muestreable aprox. :  %

Hora de la Medición 16:50	Ajuste de Marea (mt) 0.4	Prof. Máxima 190,8 Observ.	Prof. Mínima 178,4 Observ.	Ajustada 191,2	Ajustada 178,8
------------------------------	-----------------------------	----------------------------------	----------------------------------	-------------------	-------------------

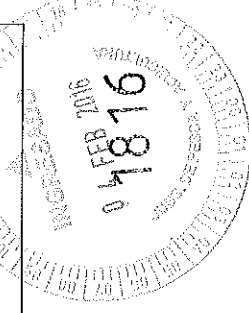

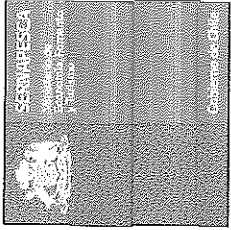

Posición geográfica de los extremos de las unidades de Muestreo (boyerines)

	Latitud	Longitud	Latitud	Longitud
Transecta N°1	_____	_____	_____	_____
Transecta N°2	_____	_____	_____	_____
Transecta N°3	_____	_____	_____	_____
Transecta N°4	_____	_____	_____	_____
Transecta N°5	_____	_____	_____	_____
Transecta N°6	_____	_____	_____	_____

Nombre Inspector

Cynthia Agüero Negrón

Firma Inspector

*Cynthia Agüero Negrón*

Nombre Capitán/Buzo

Firma Capitán/Buzo

*Heber Díaz*

# PERT 213122273

FECHA: 03-12-2015 HORA INICIO 16:50 HORA TERMINO 17:15

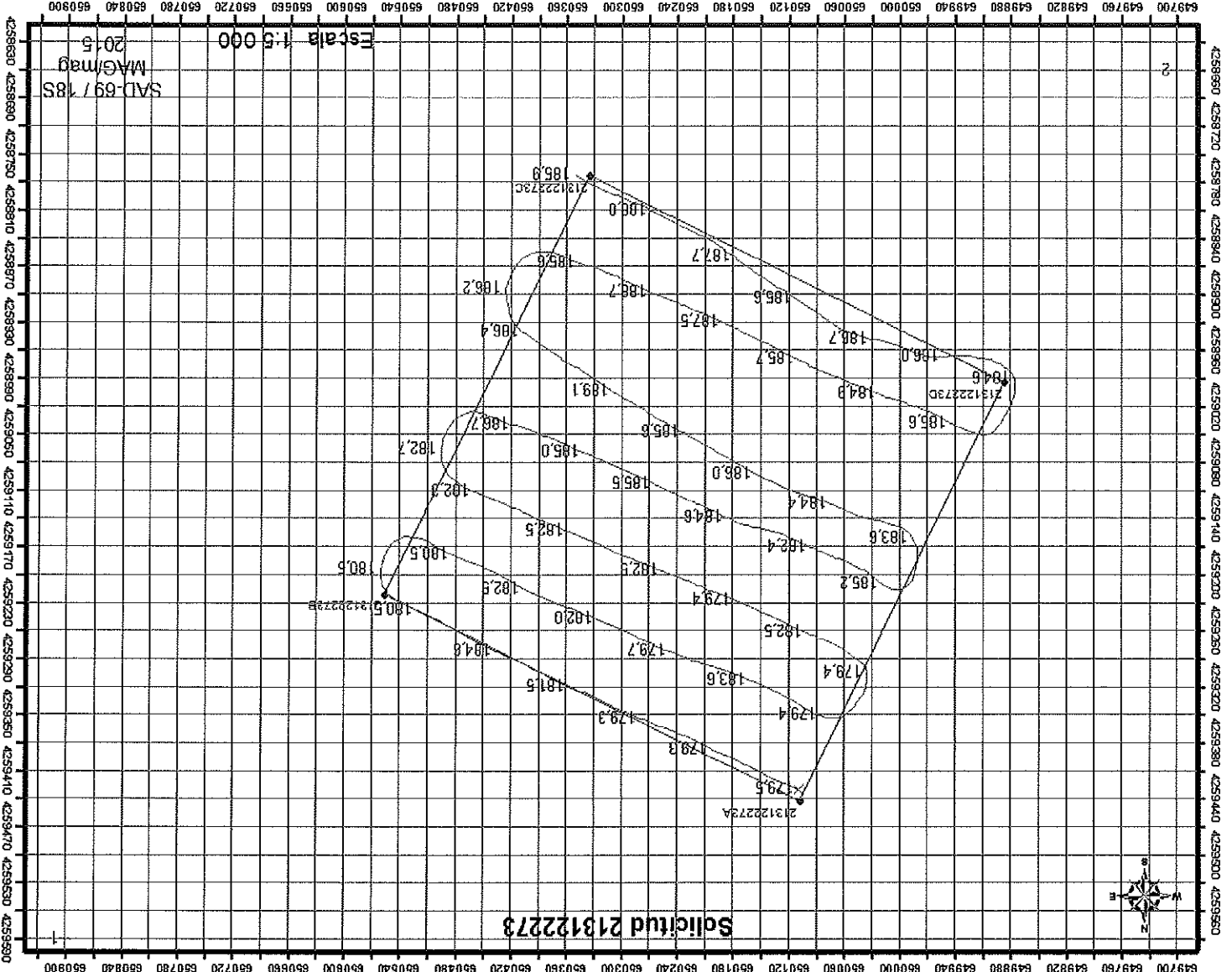

Scale 1:6399

SOFTWARE NAME & VERSION  
GPSU 5.11.1 (Hector Diaz Diaz)

Zona	Este	Norte	Profundidad (m)	PERT	Distancia (m)
18F	650109	4259430	179.5	213122273	
18F	650123	4259424	182.9	0	14
18F	650125	4259423	179.2	0	17
18F	650128	4259422	180.8	0	20
18F	650131	4259421	178.7	0	23
18F	650136	4259418	181.5	0	29
18F	650147	4259413	179.8	0	42
18F	650164	4259404	180.8	0	60
18F	650167	4259403	178.4	0	63
18F	650172	4259400	178.7	0	70
18F	650175	4259398	181.6	0	73
18F	650178	4259397	179.7	0	76
18F	650201	4259387	179.3	0	101
18F	650204	4259385	181.5	0	104
18F	650215	4259380	180	0	117
18F	650221	4259377	182.7	0	123
18F	650223	4259376	181.5	0	126
18F	650232	4259372	182.2	0	135
18F	650238	4259370	179.4	0	142
18F	650241	4259368	181.8	0	145
18F	650252	4259364	181.5	0	157
18F	650255	4259363	180.3	0	160
18F	650258	4259362	182.2	0	163
18F	650261	4259361	179.4	0	166
18F	650264	4259360	182.9	0	169
18F	650267	4259359	179.4	0	172
18F	650269	4259357	179.4	0	175
18F	650272	4259356	182.6	0	179
18F	650275	4259355	182.2	0	182
18F	650278	4259354	179.3	0	185
18F	650281	4259353	179.3	0	188
18F	650290	4259349	182.9	0	197
18F	650292	4259348	180.8	0	200
18F	650295	4259347	182.2	0	203
18F	650298	4259346	179.7	0	206
18F	650304	4259343	182.2	0	213
18F	650307	4259342	179.4	0	216
18F	650310	4259340	182.9	0	219
18F	650341	4259326	182.9	0	254
18F	650344	4259325	181.4	0	257
18F	650350	4259323	181.6	0	263
18F	650353	4259321	183.6	0	266
18F	650356	4259320	181.5	0	269
18F	650364	4259316	183.4	0	279
18F	650370	4259313	180.8	0	285
18F	650379	4259309	182.5	0	295
18F	650384	4259306	180.5	0	301
18F	650387	4259305	182.5	0	304
18F	650390	4259303	180.9	0	307
18F	650396	4259300	181.5	0	314
18F	650398	4259299	183.6	0	317
18F	650401	4259298	180.5	0	320
18F	650410	4259293	181.5	0	329
18F	650412	4259292	183.2	0	332
18F	650415	4259291	181.9	0	335
18F	650421	4259288	185.6	0	342
18F	650429	4259284	183.9	0	351
18F	650432	4259283	180.9	0	354
18F	650435	4259282	184.6	0	357
18F	650438	4259281	184.8	0	360
18F	650441	4259279	181.5	0	363
18F	650444	4259278	183.6	0	367
18F	650447	4259277	183.6	0	370
18F	650452	4259274	181.5	0	376
18F	650464	4259268	180.6	0	389
18F	650467	4259266	184.6	0	392
18F	650469	4259265	181.5	0	396

18F	650478	4259260	181.2	0	405
18F	650481	4259258	184.6	0	408
18F	650486	4259255	182.4	0	415
18F	650489	4259254	183.1	0	418
18F	650495	4259251	182	0	424
18F	650497	4259249	183.6	0	427
18F	650500	4259248	181.1	0	431
18F	650506	4259245	181.8	0	437
18F	650509	4259243	183.6	0	440
18F	650511	4259242	181.5	0	443
18F	650520	4259238	180.5	0	452
18F	650529	4259234	182.6	0	462
18F	650531	4259233	180.5	0	465
18F	650534	4259231	182.5	0	468
18F	650540	4259228	182.8	0	475
18F	650545	4259227	184.6	0	478
18F	650545	4259225	181.1	0	481
18F	650553	4259219	181.8	0	490
18F	650554	4259217	185.6	0	493
18F	650557	4259213	181	0	498
18F	650559	4259210	184.2	0	501
18F	650559	4259207	180.5	0	504
18F	650560	4259204	182.1	0	507
18F	650560	4259199	180.9	0	513
18F	650560	4259196	183.6	0	515
18F	650560	4259194	180.5	0	518
18F	650567	4259184	181.4	0	528
18F	650566	4259182	183.6	0	530
18F	650566	4259180	180.5	0	532
18F	650554	4259175	182.1	0	537
18F	650553	4259174	180.5	0	539
18F	650551	4259170	180.5	0	543
18F	650550	4259168	183.2	0	546
18F	650548	4259166	180.5	0	548
18F	650545	4259164	181.6	0	552
18F	650534	4259159	181.4	0	564
18F	650532	4259159	184.2	0	566
18F	650530	4259159	181.1	0	568
18F	650528	4259160	182.5	0	570
18F	650520	4259160	183.6	0	577
18F	650519	4259161	180.5	0	579
18F	650515	4259162	180.7	0	583
18F	650513	4259163	183.6	0	585
18F	650509	4259164	180.5	0	589
18F	650506	4259167	183.6	0	593
18F	650502	4259169	181.1	0	598
18F	650490	4259176	180.5	0	611
18F	650486	4259177	182.5	0	616
18F	650482	4259179	180.5	0	620
18F	650479	4259180	182.5	0	623
18F	650477	4259181	180.5	0	625
18F	650473	4259183	184.5	0	630
18F	650471	4259184	181.5	0	632
18F	650468	4259185	183.6	0	635
18F	650466	4259185	180.9	0	637
18F	650464	4259186	180.6	0	640
18F	650459	4259188	182.5	0	645
18F	650452	4259191	182.9	0	652
18F	650450	4259192	186.7	0	654
18F	650447	4259193	182.9	0	657
18F	650434	4259198	181.2	0	672
18F	650430	4259201	183.6	0	677
18F	650428	4259202	181.9	0	679
18F	650425	4259204	183.6	0	682
18F	650421	4259206	180.5	0	687
18F	650417	4259208	180.5	0	692
18F	650414	4259210	185.6	0	694
18F	650412	4259211	183.6	0	697
18F	650410	4259212	180.5	0	700
18F	650405	4259215	182.5	0	705
18F	650399	4259218	182.1	0	712

18F	650396	4259219	180.5	0	714
18F	650394	4259220	182.5	0	717
18F	650387	4259223	181.9	0	725
18F	650385	4259224	183.6	0	727
18F	650383	4259225	181.5	0	730
18F	650380	4259226	183.6	0	732
18F	650378	4259227	181.5	0	735
18F	650376	4259228	184.6	0	737
18F	650368	4259231	180.5	0	745
18F	650364	4259233	182.1	0	750
18F	650357	4259235	180.6	0	757
18F	650354	4259236	182.5	0	760
18F	650352	4259237	180.5	0	762
18F	650345	4259240	180.7	0	770
18F	650343	4259241	182.5	0	772
18F	650340	4259242	180.9	0	775
18F	650338	4259243	180.5	0	777
18F	650335	4259244	182.5	0	780
18F	650326	4259248	182	0	791
18F	650324	4259249	180.5	0	793
18F	650321	4259250	184.6	0	795
18F	650317	4259252	181.9	0	800
18F	650314	4259253	184.2	0	803
18F	650310	4259254	181.5	0	808
18F	650296	4259260	182.7	0	823
18F	650294	4259261	180.5	0	825
18F	650291	4259262	180.5	0	828
18F	650289	4259263	183.6	0	831
18F	650282	4259267	181.9	0	839
18F	650279	4259268	184.6	0	841
18F	650275	4259270	180	0	846
18F	650272	4259271	179.4	0	849
18F	650270	4259272	181.8	0	851
18F	650268	4259273	179.4	0	854
18F	650265	4259274	181.8	0	856
18F	650263	4259275	180.1	0	859
18F	650261	4259276	181.9	0	861
18F	650256	4259279	179.7	0	867
18F	650254	4259280	181.5	0	869
18F	650252	4259281	179.4	0	872
18F	650247	4259282	179.7	0	877
18F	650244	4259283	182.9	0	879
18F	650240	4259285	179.4	0	884
18F	650237	4259286	180	0	887
18F	650235	4259287	182.9	0	890
18F	650227	4259290	182.9	0	898
18F	650225	4259291	179.4	0	900
18F	650222	4259292	179.7	0	903
18F	650220	4259293	183.6	0	905
18F	650217	4259293	184.2	0	908
18F	650212	4259295	181.5	0	913
18F	650210	4259295	180.8	0	916
18F	650207	4259296	182.1	0	919
18F	650202	4259297	179.9	0	924
18F	650197	4259299	180.1	0	929
18F	650195	4259300	182.6	0	931
18F	650192	4259300	180.5	0	934
18F	650190	4259301	182.2	0	937
18F	650182	4259304	180.9	0	944
18F	650180	4259305	182.5	0	947
18F	650175	4259307	180.1	0	952
18F	650160	4259313	183.6	0	968
18F	650158	4259314	181.9	0	971
18F	650151	4259317	182.2	0	979
18F	650148	4259318	184.6	0	982
18F	650146	4259319	182.9	0	984
18F	650132	4259326	181.4	0	1000
18F	650129	4259327	183.2	0	1002
18F	650127	4259328	181.1	0	1005
18F	650110	4259338	181	0	1024
18F	650108	4259339	178.4	0	1027

18F	650105	4259341	183,6	0	1030
18F	650096	4259346	181	0	1041
18F	650093	4259348	182,5	0	1044
18F	650091	4259349	180,5	0	1046
18F	650086	4259351	181,1	0	1051
18F	650084	4259351	179,4	0	1054
18F	650081	4259352	184,9	0	1056
18F	650079	4259353	180,4	0	1059
18F	650076	4259353	181,6	0	1062
18F	650062	4259353	179,8	0	1076
18F	650049	4259342	180,2	0	1093
18F	650047	4259340	182,2	0	1095
18F	650046	4259338	179,9	0	1098
18F	650039	4259328	180,8	0	1110
18F	650037	4259323	179,8	0	1115
18F	650036	4259321	182,2	0	1117
18F	650036	4259319	179,4	0	1120
18F	650035	4259313	180,3	0	1125
18F	650035	4259311	183,6	0	1128
18F	650035	4259306	179,4	0	1132
18F	650035	4259304	180,8	0	1135
18F	650038	4259297	180,4	0	1142
18F	650061	4259279	181,5	0	1172
18F	650071	4259274	180,5	0	1182
18F	650084	4259269	180,5	0	1196
18F	650087	4259258	183,6	0	1199
18F	650089	4259267	180,5	0	1202
18F	650092	4259265	183,6	0	1205
18F	650097	4259264	180,5	0	1210
18F	650100	4259262	182,5	0	1213
18F	650103	4259261	180,9	0	1216
18F	650111	4259258	183,8	0	1225
18F	650116	4259255	180,5	0	1231
18F	650141	4259243	181,3	0	1259
18F	650147	4259241	183,6	0	1265
18F	650153	4259238	183,3	0	1272
18F	650158	4259235	181,3	0	1278
18F	650164	4259233	183,1	0	1284
18F	650167	4259232	180,8	0	1287
18F	650173	4259229	181,9	0	1294
18F	650176	4259228	179,4	0	1297
18F	650185	4259224	182,9	0	1306
18F	650199	4259218	181,2	0	1322
18F	650208	4259215	181,9	0	1331
18F	650214	4259212	181	0	1338
18F	650217	4259211	183,6	0	1341
18F	650220	4259210	180,5	0	1344
18F	650225	4259207	183,6	0	1350
18F	650229	4259206	180,5	0	1354
18F	650232	4259205	183,6	0	1357
18F	650235	4259204	181,9	0	1360
18F	650249	4259198	183,2	0	1376
18F	650252	4259197	181,5	0	1379
18F	650255	4259196	182,5	0	1382
18F	650261	4259194	182,1	0	1388
18F	650264	4259192	184,6	0	1391
18F	650270	4259190	183,6	0	1398
18F	650273	4259189	184,6	0	1401
18F	650276	4259188	182,5	0	1404
18F	650279	4259187	184,6	0	1408
18F	650288	4259183	182,7	0	1417
18F	650297	4259180	182,5	0	1427
18F	650300	4259179	184,6	0	1430
18F	650303	4259177	182,5	0	1433
18F	650329	4259166	182,4	0	1462
18F	650358	4259153	182,5	0	1493
18F	650361	4259152	184,6	0	1496
18F	650367	4259150	181,9	0	1503
18F	650373	4259147	184,6	0	1509
18F	650376	4259146	181,5	0	1512
18F	650382	4259144	183,6	0	1519



18F	650385	4259142	181.5	0	1522
18F	650388	4259141	182.5	0	1525
18F	650405	4259133	182.2	0	1545
18F	650408	4259132	183.6	0	1548
18F	650411	4259130	181.5	0	1551
18F	650417	4259128	184.6	0	1557
18F	650420	4259127	184.8	0	1560
18F	650422	4259126	182.5	0	1563
18F	650460	4259111	182.3	0	1603
18F	650471	4259106	183.8	0	1615
18F	650477	4259102	183	0	1622
18F	650486	4259095	182.8	0	1634
18F	650488	4259092	185.6	0	1637
18F	650490	4259090	182.5	0	1640
18F	650491	4259087	185.6	0	1643
18F	650494	4259082	182.5	0	1649
18F	650495	4259076	184.6	0	1655
18F	650495	4259066	182.7	0	1655
18F	650495	4259063	184.6	0	1665
18F	650494	4259058	184.4	0	1668
18F	650494	4259056	183.9	0	1673
18F	650491	4259049	185.3	0	1675
18F	650488	4259043	183.6	0	1682
18F	650484	4259038	185.6	0	1689
18F	650483	4259036	183.6	0	1696
18F	650480	4259033	185.9	0	1698
18F	650477	4259031	184.6	0	1702
18F	650458	4259027	184.6	0	1706
18F	650460	4259024	188.7	0	1716
18F	650458	4259025	184.6	0	1725
18F	650448	4259028	185.1	0	1727
18F	650447	4259029	187.1	0	1736
18F	650443	4259030	187.2	0	1738
18F	650441	4259031	184.6	0	1742
18F	650435	4259034	186.2	0	1744
18F	650431	4259035	184.7	0	1751
18F	650429	4259036	186.2	0	1755
18F	650426	4259037	184.6	0	1758
18F	650422	4259038	186.7	0	1760
18F	650420	4259039	184.6	0	1764
18F	650417	4259040	186.7	0	1767
18F	650415	4259040	184.6	0	1769
18F	650403	4259044	186.2	0	1772
18F	650398	4259045	184.6	0	1784
18F	650396	4259046	186.7	0	1789
18F	650384	4259051	184.7	0	1791
18F	650382	4259051	187.7	0	1804
18F	650380	4259052	184.6	0	1806
18F	650378	4259053	186.7	0	1809
18F	650375	4259054	184.6	0	1811
18F	650359	4259061	184.8	0	1814
18F	650357	4259062	184.8	0	1831
18F	650354	4259063	186.2	0	1834
18F	650345	4259067	184.6	0	1836
18F	650340	4259069	184.8	0	1847
18F	650338	4259070	185	0	1852
18F	650333	4259072	186.7	0	1854
18F	650331	4259073	184.6	0	1860
18F	650328	4259074	186.7	0	1862
18F	650326	4259075	184.6	0	1865
18F	650321	4259077	186.7	0	1867
18F	650317	4259079	185	0	1867
18F	650315	4259080	187.7	0	1872
18F	650310	4259082	185.6	0	1877
18F	650298	4259087	185.9	0	1880
18F	650291	4259090	183.9	0	1885
18F	650286	4259092	186	0	1898
18F	650279	4259095	182.5	0	1905
18F	650277	4259096	187.7	0	1910
18F	650272	4259098	183.6	0	1918
18F	650270	4259099	187.7	0	1920
18F			184.2	0	1925
18F				0	1928

18F	550268	4259100	186.2	0	1931
18F	550263	4259103	185.5	0	1936
18F	550261	4259104	187.7	0	1938
18F	550259	4259105	185.2	0	1941
18F	550245	4259112	185.6	0	1938
18F	550243	4259113	187.7	0	1959
18F	550238	4259115	183.6	0	1964
18F	550236	4259116	185.6	0	1966
18F	550229	4259119	186.1	0	1974
18F	550226	4259120	187.7	0	1976
18F	550224	4259121	185	0	1979
18F	550220	4259123	186.7	0	1984
18F	550217	4259124	183.6	0	1986
18F	550215	4259125	185.6	0	1989
18F	550206	4259129	183.7	0	1999
18F	550201	4259131	187.7	0	2004
18F	550198	4259132	182.9	0	2007
18F	550192	4259136	183.6	0	2014
18F	550189	4259137	182.5	0	2017
18F	550185	4259139	184.6	0	2022
18F	550182	4259140	181.5	0	2024
18F	550180	4259141	184.6	0	2027
18F	550173	4259144	183.4	0	2035
18F	550171	4259145	181.5	0	2037
18F	550166	4259147	183.2	0	2042
18F	550163	4259147	181.5	0	2045
18F	550158	4259149	182.1	0	2050
18F	550153	4259150	184.6	0	2055
18F	550151	4259150	184.8	0	2058
18F	550148	4259151	182.5	0	2060
18F	550141	4259152	183	0	2068
18F	550138	4259153	181.5	0	2070
18F	550131	4259155	183.6	0	2078
18F	550124	4259158	182.9	0	2086
18F	550122	4259159	184.6	0	2088
18F	550119	4259160	182.5	0	2091
18F	550117	4259161	184.6	0	2093
18F	550112	4259163	182.5	0	2098
18F	550096	4259170	182.4	0	2116
18F	550093	4259171	184.6	0	2119
18F	550089	4259173	183.6	0	2124
18F	550086	4259174	185.6	0	2126
18F	550084	4259175	182.5	0	2129
18F	550081	4259176	187.7	0	2132
18F	550077	4259178	182.5	0	2137
18F	550072	4259180	182	0	2142
18F	550070	4259181	185.6	0	2144
18F	550068	4259182	181.5	0	2147
18F	550065	4259183	183.2	0	2149
18F	550059	4259185	181.9	0	2156
18F	550054	4259187	183.6	0	2161
18F	550052	4259188	181.5	0	2164
18F	550050	4259189	183.6	0	2166
18F	550043	4259193	181.9	0	2174
18F	550040	4259194	184.2	0	2176
18F	550038	4259195	181.5	0	2179
18F	550034	4259197	182.1	0	2183
18F	550033	4259199	179.4	0	2186
18F	550031	4259200	179.4	0	2188
18F	550029	4259201	183.6	0	2190
18F	550027	4259203	181.5	0	2193
18F	550023	4259206	183.2	0	2198
18F	550021	4259208	181.5	0	2200
18F	550017	4259210	185.2	0	2205
18F	550012	4259213	181.5	0	2210
18F	550008	4259215	184.6	0	2215
18F	550006	4259216	182.5	0	2218
18F	649997	4259215	182.3	0	2227
18F	649990	4259211	183	0	2235
18F	649988	4259209	184.6	0	2237
18F	649985	4259204	183.1	0	2243

18F	649980	4259184	183.8	0	2263
18F	649980	4259182	185.6	0	2266
18F	649981	4259172	186.2	0	2276
18F	649982	4259169	183.6	0	2278
18F	649985	4259161	183.6	0	2288
18F	649989	4259156	185.9	0	2293
18F	649995	4259151	184.2	0	2301
18F	649997	4259150	186.7	0	2304
18F	650001	4259148	183.9	0	2309
18F	650011	4259145	184.4	0	2319
18F	650014	4259144	187.7	0	2321
18F	650016	4259143	184.6	0	2324
18F	650021	4259142	184.5	0	2329
18F	650024	4259141	182.5	0	2332
18F	650037	4259139	183.7	0	2346
18F	650040	4259138	185.6	0	2349
18F	650043	4259137	183.6	0	2351
18F	650051	4259133	184.6	0	2360
18F	650054	4259132	182.5	0	2363
18F	650073	4259124	184.4	0	2384
18F	650082	4259121	183.6	0	2394
18F	650085	4259120	185.6	0	2397
18F	650109	4259113	183.5	0	2422
18F	650115	4259111	186.2	0	2428
18F	650120	4259108	185.6	0	2434
18F	650123	4259107	187.7	0	2437
18F	650126	4259106	183.6	0	2440
18F	650137	4259100	184.2	0	2453
18F	650140	4259099	185.6	0	2456
18F	650149	4259095	183.6	0	2465
18F	650155	4259093	186	0	2472
18F	650191	4259072	185.9	0	2513
18F	650193	4259070	187.7	0	2516
18F	650196	4259069	185.6	0	2519
18F	650199	4259067	188.7	0	2522
18F	650207	4259062	187.7	0	2532
18F	650210	4259061	189.7	0	2535
18F	650212	4259059	186.2	0	2538
18F	650215	4259058	185.9	0	2541
18F	650226	4259051	185.7	0	2554
18F	650229	4259050	187.3	0	2557
18F	650232	4259048	185.6	0	2560
18F	650238	4259046	185.6	0	2567
18F	650240	4259044	186	0	2570
18F	650243	4259043	186.7	0	2573
18F	650246	4259041	188.7	0	2576
18F	650251	4259038	185.8	0	2582
18F	650254	4259036	188.7	0	2586
18F	650260	4259033	189	0	2592
18F	650265	4259030	185.5	0	2598
18F	650268	4259028	188.7	0	2602
18F	650271	4259026	185	0	2605
18F	650276	4259023	186.1	0	2611
18F	650279	4259021	184.6	0	2614
18F	650284	4259018	188.1	0	2620
18F	650289	4259015	186.4	0	2627
18F	650292	4259014	189.7	0	2630
18F	650295	4259012	186.7	0	2633
18F	650298	4259010	186.7	0	2636
18F	650300	4259009	189.7	0	2639
18F	650303	4259007	186.7	0	2642
18F	650308	4259004	189.1	0	2649
18F	650311	4259002	185.6	0	2652
18F	650319	4258997	187.8	0	2661
18F	650327	4258992	183.6	0	2661
18F	650332	4258988	187.3	0	2677
18F	650335	4258987	185.6	0	2680
18F	650348	4258978	186.8	0	2696
18F	650351	4258977	186.1	0	2699
18F	650357	4258974	187.1	0	2705
18F	650365	4258969	185.8	0	2715

18F	650367	4258967	189.7	0	0	2718
18F	650370	4258965	185.6	0	0	2721
18F	650407	4258941	186.4	0	0	2765
18F	650409	4258939	187.2	0	0	2769
18F	650412	4258937	185.6	0	0	2772
18F	650414	4258934	187.7	0	0	2775
18F	650416	4258932	185.2	0	0	2778
18F	650422	4258921	186.9	0	0	2790
18F	650423	4258919	184.6	0	0	2793
18F	650423	4258916	187.3	0	0	2796
18F	650425	4258905	187.7	0	0	2807
18F	650426	4258894	186.2	0	0	2818
18F	650419	4258874	186.2	0	0	2838
18F	650417	4258872	188.7	0	0	2841
18F	650416	4258870	185.6	0	0	2844
18F	650413	4258866	187.1	0	0	2849
18F	650409	4258863	186.6	0	0	2854
18F	650408	4258861	184.6	0	0	2856
18F	650398	4258856	186.2	0	0	2867
18F	650389	4258854	185.6	0	0	2876
18F	650387	4258854	188.7	0	0	2878
18F	650381	4258854	189.5	0	0	2884
18F	650376	4258855	188.3	0	0	2889
18F	650372	4258856	189.1	0	0	2893
18F	650370	4258857	185.6	0	0	2896
18F	650361	4258860	185.6	0	0	2905
18F	650359	4258861	188.7	0	0	2907
18F	650357	4258862	185.6	0	0	2910
18F	650345	4258866	185.6	0	0	2921
18F	650341	4258868	188.7	0	0	2926
18F	650336	4258869	185.6	0	0	2931
18F	650333	4258869	188.7	0	0	2934
18F	650331	4258870	188.7	0	0	2936
18F	650329	4258871	186.2	0	0	2939
18F	650326	4258872	188.7	0	0	2942
18F	650323	4258875	184.6	0	0	2949
18F	650307	4258880	186.3	0	0	2952
18F	650305	4258880	189.7	0	0	2964
18F	650303	4258882	185.6	0	0	2967
18F	650275	4258894	185.9	0	0	2998
18F	650267	4258898	188.7	0	0	3005
18F	650265	4258899	186.7	0	0	3008
18F	650258	4258901	184.6	0	0	3016
18F	650253	4258903	187.7	0	0	3021
18F	650249	4258905	187.7	0	0	3026
18F	650246	4258906	185.6	0	0	3028
18F	650241	4258908	188.7	0	0	3033
18F	650237	4258910	188.2	0	0	3038
18F	650234	4258911	185.6	0	0	3041
18F	650232	4258912	187.7	0	0	3044
18F	650229	4258913	185.6	0	0	3046
18F	650227	4258914	188.7	0	0	3049
18F	650222	4258916	185.6	0	0	3054
18F	650210	4258921	184.6	0	0	3067
18F	650208	4258922	187.1	0	0	3070
18F	650194	4258928	185.8	0	0	3085
18F	650189	4258930	187.5	0	0	3090
18F	650187	4258932	185.6	0	0	3093
18F	650184	4258933	187.7	0	0	3095
18F	650182	4258934	185.6	0	0	3098
18F	650180	4258935	187.7	0	0	3101
18F	650175	4258937	185.6	0	0	3106
18F	650171	4258940	187.7	0	0	3111
18F	650166	4258942	185.4	0	0	3116
18F	650152	4258949	185.2	0	0	3132
18F	650147	4258951	186.8	0	0	3137
18F	650142	4258953	185.6	0	0	3142
18F	650140	4258954	187.7	0	0	3145
18F	650138	4258955	185.6	0	0	3147
18F	650130	4258959	187.7	0	0	3155
18F	650126	4258961	185.6	0	0	3160

18F	650121	4258964	187.7	0	0	3166
18F	650119	4258965	184.6	0	0	3168
18F	650109	4258970	185.7	0	0	3179
18F	650107	4258971	184.6	0	0	3181
18F	650100	4258974	185.5	0	0	3189
18F	650098	4258976	189.7	0	0	3192
18F	650095	4258977	185.6	0	0	3194
18F	650091	4258979	185.2	0	0	3200
18F	650054	4258994	185.4	0	0	3239
18F	650052	4258995	186.7	0	0	3241
18F	650049	4258996	184.6	0	0	3244
18F	650042	4258999	185.5	0	0	3252
18F	650020	4259007	184.9	0	0	3275
18F	650018	4259008	187.7	0	0	3278
18F	650016	4259009	184.6	0	0	3280
18F	650013	4259010	187.7	0	0	3283
18F	650011	4259011	185.6	0	0	3286
18F	649993	4259016	187	0	0	3304
18F	649991	4259017	184.6	0	0	3306
18F	649989	4259018	189.7	0	0	3309
18F	649981	4259020	184.6	0	0	3316
18F	649979	4259021	187.7	0	0	3319
18F	649972	4259024	184.8	0	0	3327
18F	649965	4259027	186.3	0	0	3334
18F	649955	4259032	184.9	0	0	3345
18F	649953	4259033	186.7	0	0	3347
18F	649946	4259037	183.6	0	0	3355
18F	649944	4259038	185.6	0	0	3358
18F	649934	4259042	185.7	0	0	3368
18F	649930	4259044	187.5	0	0	3373
18F	649927	4259045	185	0	0	3376
18F	649920	4259048	186.4	0	0	3383
18F	649915	4259049	184.7	0	0	3388
18F	649910	4259050	186.7	0	0	3393
18F	649908	4259050	184.5	0	0	3395
18F	649906	4259050	186.7	0	0	3399
18F	649903	4259049	183.6	0	0	3400
18F	649899	4259048	187.7	0	0	3405
18F	649879	4259038	187.1	0	0	3418
18F	649878	4259014	187	0	0	3441
18F	649877	4259012	184.6	0	0	3444
18F	649876	4259009	186.7	0	0	3447
18F	649875	4259004	184.6	0	0	3450
18F	649875	4259001	184.6	0	0	3455
18F	649874	4258998	186.7	0	0	3458
18F	649874	4258998	183.6	0	0	3461
18F	649875	4258996	186.7	0	0	3463
18F	649875	4258991	184.6	0	0	3468
18F	649876	4258989	188.3	0	0	3471
18F	649878	4258984	184.6	0	0	3476
18F	649891	4258973	184.8	0	0	3492
18F	649893	4258973	185.7	0	0	3495
18F	649898	4258971	184.6	0	0	3499
18F	649900	4258970	187.3	0	0	3502
18F	649902	4258970	185	0	0	3504
18F	649910	4258968	184.9	0	0	3512
18F	649913	4258968	186.7	0	0	3514
18F	649915	4258968	184.6	0	0	3517
18F	649918	4258967	186.7	0	0	3520
18F	649923	4258966	184.6	0	0	3525
18F	649929	4258966	186.7	0	0	3531
18F	649932	4258966	184.6	0	0	3534
18F	649935	4258966	186.7	0	0	3537
18F	649938	4258966	184.6	0	0	3540
18F	649943	4258966	184.6	0	0	3545
18F	649952	4258967	186	0	0	3554
18F	649955	4258967	187.7	0	0	3557
18F	649958	4258967	184.6	0	0	3560
18F	649961	4258967	187.7	0	0	3563
18F	649964	4258967	184.6	0	0	3566
18F	649975	4258964	186.3	0	0	3578

18F	649984	4258961	184.6	0	3587
18F	649987	4258960	188.3	0	3590
18F	649990	4258959	184.6	0	3593
18F	649993	4258958	187.7	0	3596
18F	649998	4258956	184.6	0	3602
18F	650004	4258954	187.7	0	3608
18F	650010	4258952	187.5	0	3614
18F	650013	4258951	185.6	0	3618
18F	650017	4258950	187.7	0	3621
18F	650023	4258949	184.6	0	3627
18F	650026	4258948	187.7	0	3630
18F	650029	4258948	186.7	0	3633
18F	650035	4258947	188.7	0	3639
18F	650041	4258945	184.6	0	3645
18F	650059	4258939	185.2	0	3664
18F	650062	4258938	186.7	0	3668
18F	650064	4258936	184.6	0	3671
18F	650067	4258935	186.7	0	3674
18F	650072	4258931	187.1	0	3680
18F	650093	4258917	185.5	0	3705
18F	650103	4258910	187.8	0	3718
18F	650112	4258905	185.6	0	3727
18F	650114	4258903	188.3	0	3731
18F	650120	4258900	187.5	0	3737
18F	650123	4258898	189.7	0	3740
18F	650125	4258896	186.7	0	3743
18F	650131	4258893	186.5	0	3750
18F	650134	4258891	184.6	0	3753
18F	650144	4258884	184.7	0	3756
18F	650150	4258880	185	0	3772
18F	650152	4258879	188.1	0	3776
18F	650160	4258873	188	0	3785
18F	650168	4258868	185.9	0	3795
18F	650176	4258862	190.8	0	3804
18F	650178	4258860	187.7	0	3808
18F	650189	4258853	187.9	0	3820
18F	650191	4258851	185.6	0	3824
18F	650199	4258845	185.2	0	3833
18F	650202	4258843	187.7	0	3837
18F	650213	4258837	185.8	0	3849
18F	650233	4258828	185.7	0	3871
18F	650236	4258827	188.3	0	3874
18F	650239	4258825	185.6	0	3877
18F	650250	4258819	185.4	0	3890
18F	650253	4258818	187.7	0	3893
18F	650267	4258811	188	0	3909
18F	650270	4258809	189.7	0	3912
18F	650272	4258808	185.6	0	3915
18F	650275	4258806	188.3	0	3918
18F	650281	4258803	185.6	0	3925
18F	650287	4258801	186.2	0	3931
18F	650290	4258800	188.7	0	3934
18F	650296	4258797	186.7	0	3940
18F	650298	4258796	188.7	0	3944
18F	650304	4258794	188.7	0	3950
18F	650307	4258793	190.8	0	3953
18F	650313	4258791	185.6	0	3959
18F	650316	4258790	188.1	0	3962
18F	650322	4258787	185.6	0	3969
18F	650325	4258786	187.7	0	3972
18F	650331	4258783	188.4	0	3978
18F	650334	4258782	185.6	0	3982
18F	650336	4258780	188.7	0	3985
18F	650342	4258777	186	0	3991
18F	650351	4258772	185.9	0	4001

Profundidad Max.	190.8
Profundidad Min.	178.4